

traveller™ <.....

traveller

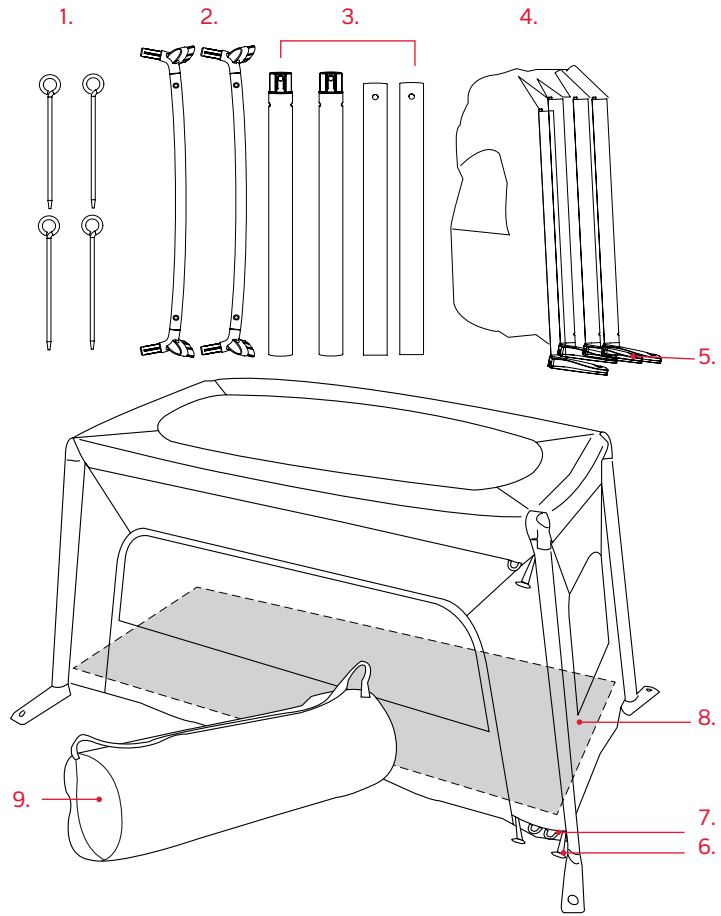

## traveller™ instructions

American Safety Standard (ASTM F406-08a) states:

Read all instructions BEFORE assembly and USE of product. KEEP INSTRUCTIONS FOR FUTURE USE.

European Safety Standard (EN716-1:2008) and French Safety Standard (XPS 54-081) states:

**IMPORTANT, RETAIN FOR FUTURE REFERENCE: READ CAREFULLY.**

Australian/New Zealand Safety Standard (AS/NZS 2195:1999) states:

**IMPORTANT. BEFORE ASSEMBLING THIS COT READ AND UNDERSTAND THE INSTRUCTIONS. INCORRECT ASSEMBLY MAY MAKE THE COT UNSAFE.**

**DO NOT USE THIS COT IF ANY PART IS BROKEN, TORN OR MISSING.**

**KEEP THESE INSTRUCTIONS IN A SAFE PLACE FOR FUTURE REFERENCE.**

Assembling your new phil&teds traveller is effortless and tool-free. Just follow these simple steps & in two minutes you'll be there.

### bits & bobs

The red numbers refer to traveller parts indicated on the first page of this guide

- 1 4 x pegs
- 2 2 x silver end rails with black connectors
- 3 4 x silver half rails
- 4 Fabric set with 4 x silver legs attached
- 5 4 x feet (attached to legs and fabric set)
- 6 Plastic toggle
- 7 Elastic loop
- 8 Self-expanding mattress
- 9 Carry bag

### safe & sound

We've attained the following safety standards:

- EN716-1:2008 EN716-2:2008
- ASTM F406-08a
- AS/NZS 2195:1999 CPN4
- CRC, c.932
- XPS 54-081

## getting started

Letters in red refer to line drawings on the inside front cover.

- a** Place the top of the traveller (large zipped mesh) face down on the ground with the four legs folded inwards on top of the fabric.
- b** Take two of the silver half rails (no.3) & snap them together to make one long rail. Repeat for the second set of rails.
- c** Slide each long rail into the fabric sleeves, one on each long side of the traveller.
- d** Attach the two shorter 'end' rails to the long 'side' rails using the plastic connectors.
- e** Zip closed the retaining flaps at the short ends of the traveller.
- f** Attach the legs to their corresponding plastic corners. Ensure all four are secure before moving on.
- g** Attach the red rubber foot tabs on the underside of each foot to the hook on the underside of the foot. Repeat for all four feet. Then turn the traveller on to its feet.
- h** Locate the zip pull toggles and elastic loops at both ends of the traveller. Feed the toggle behind the aluminium leg & through the elastic loop; securing it to the side panel. Repeat at the other end of the traveller.

- i** Remove the mattress from its packaging & open the valve. The mattress will automatically start to expand. To top it up, you can blow into the valve. When it's fully expanded secure the valve shut.
- j** To comply with the EN safety standard in the UK: Unzip the double skinned floor, insert the mattress between the two skins, then close the zip. Secure the zip by feeding the toggle behind the leg & through the elastic loop on the side panel. Rest of world: choose either the method above, or place the mattress inside the traveller itself.

**NOTE:** When the side access panel is not in use, secure it closed using the toggle & elastic loop at the base of the panel.

**WARNING** Never use the traveller without the supplied mattress.

**DO NOT** use in conjunction with any mattress other than the one supplied.

**IMPORTANT:** When outdoors anchor the cot to the ground by placing the supplied pegs through the holes in the feet.

## packing up

- k** Unfasten all the toggles from the elastic loops and remove the mattress from the traveller. Undo the valve and compress by rolling up.
- l** Turn the traveller upside down and release the four red rubber foot tabs from each foot.

- m Pull the legs upwards, releasing them from the plastic corners.
- n Unzip the two end retainer flaps and disconnect the two long rails from the plastic corners. Slide out the two long rails & disconnect them from each other by pressing the snib-lock buttons.
- o Fold the legs inwards on top of the fabric and role up as a complete set.

## add & adapt

Other phil&teds products that work fantastically with the traveller:

- metro™
- lobster™
- wriggle wrapper™

## cuts & bruises

Cleaning & caring for your product.

### The once over

Check the traveller for cuts & bruises. If your traveller is damaged in any way, or you are not sure how to use it, contact your retailer immediately.

The fabric on your traveller is highly water resistant, but zips and seams can leak.

### Caring for the traveller

- Unlike children, your traveller likes to stay clean.
- Dry your traveller thoroughly before storing.
- Remove dry dirt with a soft brush.
- Do not wash with soap, solvents, bleach,

or detergents. (these may harm the fabric). Store in a well ventilated space, away from moisture & direct sunlight (which can harm & fade your traveller's vibrant coat).

**NOTE:** Improper care will void any warranties. Do not use if deterioration is detected or suspected.

## rights & remedies

\*Consumers may have extra rights in some countries or states.

Our products are warranted against defects in materials and workmanship for one year from the date of purchase. If the product has a manufacturing fault we will repair it free of charge. If not practical to repair it, we will, at our discretion, replace the part in question. If the product fails due to wear and tear, accident, neglect or negligence, or is outside the warranty, we will happily repair it for a reasonable charge.\*

**Who is covered?** The original purchaser buying product from an authorised dealer in the same country as the purchaser. Proof of purchase is required.

**What is covered?** Workmanship or materials that are deemed by us to be faulty, providing the product has at all times been used in normal conditions in accordance with instructions, and has been properly maintained.

**What is not covered?** Second hand product, modified product, poorly maintained product, normal wear, fading and fabric cuts, improper use (by way of example): abnormal use; not following

instructions; child left unattended; excessive load; transport damage i.e. airline or freight damage.

**Customer costs within warranty** The customer is responsible for any inwards freight charge to return the product to the manufacturer or its representative for warranty and/or service.

**Customer costs outside warranty** Where proof of purchase is not provided or the product is outside of the one year warranty period, the manufacturer (or agent) reserves the right to charge a service fee and/or charge for parts replaced/repared. A return freight charge will also apply.

**Exclusions:** Any consequential loss or damage to any person or property directly or indirectly as a result of using the product.

**Who do I contact?** Consult the service and warranty section of the phil&teds website ([www.philandteds.com/warranty](http://www.philandteds.com/warranty)) which guides you through the warranty claim process.

**Note:** you will need to provide proof of purchase.

## log on & relax

Please register your product purchase through our online product registration by visiting

[www.philandteds.com](http://www.philandteds.com)

## WARNINGS

KEEP INSTRUCTIONS WITH YOUR TRAVELLER FOR FUTURE REFERENCE. INJURY MAY RESULT FROM IMPROPER USE OR NOT FOLLOWING ALL SAFETY PRECAUTIONS.

IMPORTANT – READ THE INSTRUCTIONS CAREFULLY BEFORE USE AND KEEP THEM FOR FUTURE REFERENCE.

## WARNINGS

European Safety Standard (EN716-1:2008) and French Safety Standard (XPS 54-081) states:

### WARNING

Be aware of the risk of open fire and other sources of strong heat, such as electric bar fires, gas fires, etc. in the vicinity of the cot.

### WARNING

Do not use the cot if any part is broken, torn or missing and use only spare parts approved by the manufacturer.

### WARNING

Do not leave anything in the cot or place the cot close to another product, which could provide a foothold or present a danger of suffocation or strangulation, e.g. strings, blind/curtain rods, etc.

## WARNING

Do not use more than one mattress in the cot.

Before using the traveller, ensure all locking mechanisms are engaged. Check carefully that they are all fully engaged before use.

If you leave the child unattended in the traveller, always make sure the side access panel is closed and secure.

Ensure that all components of the frame are regularly checked for a secure fit.

To prevent injury from falls, do not use the traveller when the child is able to climb out of the cot.

NOTE: The distance between the surface of the mattress and the upper part of the framework of the cot must be at least 500mm.

## WARNINGS

American Safety Standard (ASTM F406-08a) states:

### WARNING

Never leave an infant in the product with the sides down.

### WARNING

Infants can suffocate:

- In gaps between a mattress too small or too thick and product sides.
- On soft bedding.

**NEVER** add a mattress, pillow, comforter or padding.

**NEVER** use a water mattress with this product.

### WARNING

Failure to follow these warnings and the instructions could result in serious injury or death.

The product must be fully erected prior to use. Failure to install may result in child falling out of the product.

Strings can cause strangulation! Never place items with a string around a child's neck such as hood strings or pacifier cords. Never suspend strings over product or attach strings to toys.

When the child is able to pull to standing position, remove bumper pads, large toys, and other objects that could serve as steps for climbing out.

Discontinue use of the product when child is able to climb out or reaches the height of 35in. (890mm)

**NEVER** place product near a window where cords from blinds or drapes can strangle a child.

Use **ONLY** mattress/pad provided by manufacturer (which must be at least 46.85in. long by 19.68in. wide and not more than 0.98in. thick).

Always provide the supervision necessary for the continued safety of your child. When used for playing, never leave child unattended.

To reduce the risk of SIDS, paediatricians recommend healthy infants be placed

on their back to sleep, unless otherwise advised by your physician.

**NEVER** use this product if there are any loose or missing fasteners, loose joints, broken parts, or torn mesh/fabric. Check before assembly and periodically during use. Contact your retailer for replacement parts. Never substitute parts.

**NEVER** leave child in product with side lowered. Be sure side is in raised and locked position whenever child is in product.

**NEVER** use plastic shipping bags or other plastic film as mattress covers not sold and intended for that purpose. They can cause suffocation.

**NEVER** use a water mattress with this product.

## WARNINGS

Australian/New Zealand Safety Standard (AS/NZS 2195:1999 CPN4) states:

## WARNING

### MATTRESS SIZE

This cot is made to use a mattress which is 500mm wide 1190mm long and no more than 25mm thick.

Using the wrong size mattress may create hazardous gaps that could result in suffocation or could reduce the side height of the cot which may result in your child falling out of the cot.

Do not leave anything in the cot (such as toys) that provide a foothold.

Do not use the cot near naked heat sources, bar heaters, open fires or exposed flames.

Keep the cot clear of trailing cables and hanging cords.

Keep medication, and small items that a child could choke on away from the cot.

The thickness of the mattress has been specified to ensure that the distance

from the top of the mattress to the top of the lowest side or end will always be at least 500mm. This will reduce the risk of children falling out of the cot.

## WARNINGS

Canadian Safety Standard  
(CRC c.932) states:

## WARNING

Ensure every component is properly and securely in place before placing the child in the traveller.