

Monterey™

Expandable Booster

We're **EXPANDING** booster safety!



Sunshine Kids®
JUVENILE PRODUCTS

Making Travel Safe and Easy™
skjp.com



Contents

Diagrams		3-5
Section 1	Warnings	6-8
Section 2	Safety Information	9-11
Section 3	Assembly and Adjustments	12
	Booster Seat Assembly	12
	Headrest adjustment	12
	Backrest Width Adjustment	12
Booster Seat Use		
Section 4	ISOFAST Installation	12
Section 5	Booster Seat Positioning	13
Section 6	Adjusting Recline Angle	14
Section 7	Securing the Child	14
Section 8	Seat Belt Buckle Position	15
Section 9	Backless Booster Use	15
Section 10	Care and Maintenance	16
Section 11	Warranty	17

Product: Monterey child booster seat
Model: 15000
Mfg. by: Sunshine Kids Juvenile Products
3104 142nd Ave E
Sumner, WA 98390

Customer service:
Tel: 888-336-7909
Email: us-sales@skjp.com

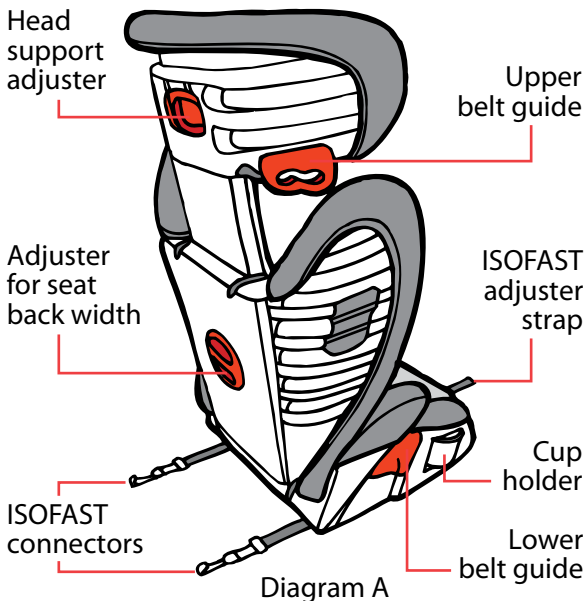
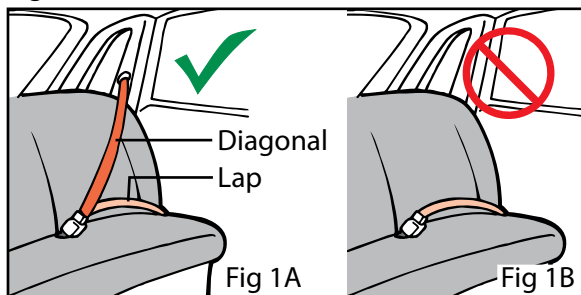

Fig 1



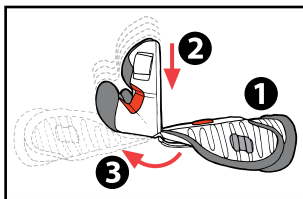

Fig 2

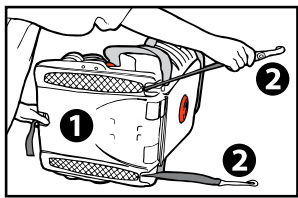

Fig 3

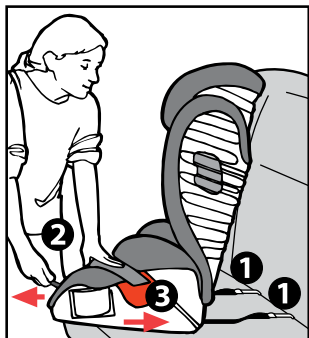

Fig 4

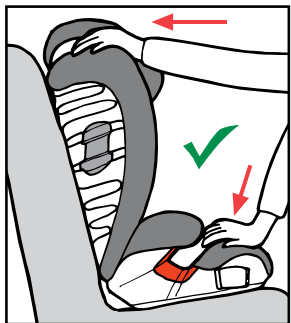

Fig 5

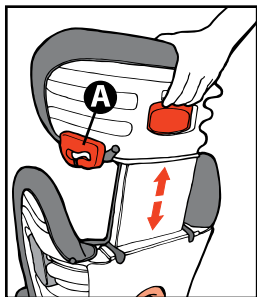

Fig 6

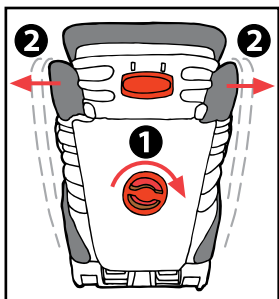

Fig 7



Fig 8

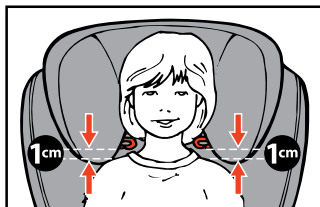

Fig 9

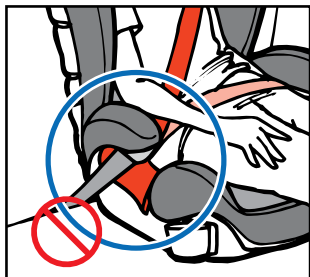

Fig 10

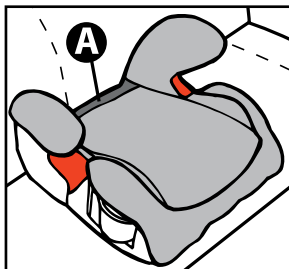

Fig 11



Fig 12



! WARNING !



Death or SERIOUS INJURY can occur

Failure to follow all written instructions and product labels can result in death or serious injury in a crash. Carefully read and understand this instruction manual prior to using this restraint. If you have any questions visit skjp.com or contact Sunshine Kids Juvenile products®. To insure proper long-term use, store this manual under the bottom of the base.

- Use only with children whose height is between 38" and 63" and whose weight is between 30 lbs and 120 lbs.
- Only use this restraint forward-facing.
- Use only the vehicle's lap and shoulder belt system when restraining the child in this booster seat. (Fig 1A)
- NEVER use with only a vehicle lap belt to restrain a child. (Fig 1 B) This could result in serious injury or death to a child.
- Some vehicle seat belt systems cannot be used with this booster seat. Read vehicle owner's manual and 'Vehicle Seat Belt Systems' section of this manual.
- DO NOT use this booster seat without the backrest unless there is vehicle headrest for that seating position.
- DO NOT use this booster seat without the backrest unless proper vehicle seat belt placement can be achieved.
- DO NOT use this booster seat with any other backrest or cushions.
- To prevent injury due to product deterioration, do not use this booster seat if it has been involved in a severe accident or if it is older than six years.
- Never leave a child alone in a vehicle, even for a short time.



! WARNING !



Death or SERIOUS INJURY can occur

- Always secure this booster seat using vehicle seat belt or LATCH anchors even when not occupied. In a crash, an unsecured item may cause injury to other vehicle occupants.
- Except as described in this manual, do not disassemble or modify any part of this booster seat or vehicle seat belt.
- Register your child restraint with the manufacturer.
- Do not place anything under the booster seat to raise it off the vehicle seat.
- This restraint is not a toy. Do not let a child play with it.
- Do not leave folding vehicle seats unlatched. In the event of a sudden stop, a loose seat back could prevent the booster seat from protecting the child as well as it should.
- In the event of an accident, the vehicle body itself provides the most significant passenger protection. While a properly installed restraint will improve chances for survival in most accidents, a booster seat will not protect a child if the vehicle is too severely impacted.
- Follow all instructions on this child restraint and in the written instructions. To insure proper long term use, store this manual under the bottom of the base.

Section 1: Warnings (continued)



! WARNING !



Death or **SERIOUS INJURY** can occur

- According to accident statistics, the National Highway Transportation Safety Administration (NHTSA) recommends that parents select the rear seat as the safest location to properly install a booster seat. Please read carefully the section concerning vehicle seat belts in this guide to insure the child's safety. If in doubt about installing this booster seat, please consult the vehicle owner's manual.



WARNING: DO NOT place a child restraint in the front seat of a vehicle with a passenger air bag unless the air bag is turned off. **DEATH** or **SERIOUS INJURY** can occur. The back seat is the safest place for children under 12.

IMPORTANT: Children who weigh 40 lbs (18kg) or less are best protected in a 5-point harness restraint. Sunshine Kids Juvenile products® recommends that children remain in a 5-point harness restraint until reaching the maximum weight or height allowed.

- If the child will not keep the vehicle shoulder belt properly positioned at all times, DO NOT use a booster seat. You must use a harnessed child restraint.

- **Maximum Child Height:** Child is too tall if the top of the ears are above the top of either the fully raised booster seat headrest or fully raised vehicle headrest.

Section 2: Safety Information

General:

Cover this booster seat if vehicle is left in direct sunlight. Portions of the booster seat can become hot enough to burn a child and cover fabric can become faded.

Store this booster seat in a safe place when not in use. Do not store near direct heat source or place heavy objects on top of it.

Always make sure vehicle seat is locked in its upright position. Reclining the vehicle seat will adversely affect the safety and performance of the child seat in an accident.

Certification:

This child restraint system conforms to all applicable Federal Motor Vehicle Safety Standards. **This restraint is not certified for use in aircraft.** Lap belts in aircraft cannot be used safely with this booster seat.

Registration:

Visit www.skjp.com to register your restraint online. Child restraints can be recalled for safety reasons. You must register this restraint to be reached in a recall. Send your name, address and this restraint's model and serial number and manufacturing date to Sunshine Kids Juvenile Products®, 3104 142nd Ave. South, Suite 105, Sumner, WA 98390, or call 1-888-336-7909. For recall information call the U.S. Government's Auto Safety Hotline at 1-888-327-4236 (TTY 1-800-424-9153) or go to www.nhtsa.gov

Section 2: Safety Information (continued)

Vehicle Seat Belt Systems:

IMPORTANT: Some vehicles have no seating positions compatible with booster seats. If in doubt, please contact the vehicle manufacturer for assistance.

WARNING: ONLY use this booster seat with a 3-point (lap-and-shoulder) vehicle seat belt that is NOT motorized or anchored to the vehicle door.

In order to protect a child in an accident, this booster must be used with a compatible vehicle seat belt.

The following seat belt types are NOT compatible with this booster seat:

- Two-point seatbelts of any kind.
- Three-point seat belts with separate retractors for lap and shoulder sections.
- Motor-driven, automatic seat belts.
- Seat belts with anchorage points on the door.



The vehicle owner's manual will have complete information on the types of seat belts in the vehicle. If the seat belt type is listed above, choose another seating position in the vehicle.

Section 2: Safety Information (continued)

Vehicle Seating Positions:

Sunshine Kids Juvenile Products® and the U.S. Department of Transportation warn that children under 12 must ride in the rear seats and away from front airbags. The only exception is if the airbag is turned off. When using a vehicle with airbags, refer to the vehicle owner's manual for additional booster seat installation instructions and precautions.

WARNING: Only use this booster seat in forward-facing vehicle seats. DO NOT use this booster seat in side-facing or rear-facing seats in vans or station wagons.

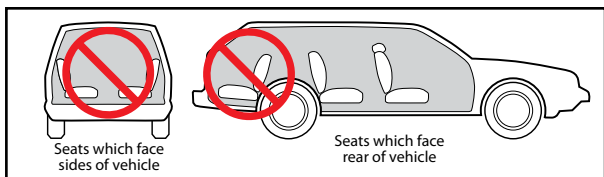

Cup Holders:

Cup holders are located on both sides of seat bottom: swivel outward to the locked position for use. Swivel inward to the recessed and locked position when not in use.

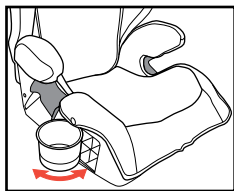

IMPORTANT: Do not step on or put excess weight on cup holder which could cause it to break.

Caution: DO NOT use with hot liquids as this could burn a child.

Section 3: Assembly and Adjustments

Attaching the Backrest:

- 1) Lay backrest on flat surface with front facing down. (Fig 2.1)
- 2) Slide seat bottom at 90 angle onto backrest hooks. (Fig 2.2)
- 3) Rotate seat bottom downwards and under back rest until a 'click' is heard and the seat shape is formed. (Fig 2.3)

Removing backrest: follow above instructions in reverse.

Adjusting Headrest:

Squeeze the red adjuster on back of booster seat head rest while adjusting its height up or down to fit the child. (Fig 6)

Adjusting Backrest width:

This booster seat features a unique, width-adjusting seat back to best fit a growing child as well as seasonal clothing. Turn the dial on the back of the backrest (Fig 7) to adjust its width: turn clockwise (Fig 7.1) to increase backrest width (Fig 7.2), turn counter-clockwise to make backrest narrower. Suggestion: It may be easier to adjust backrest to proper width prior to securing the booster seat installation using ISOFAST.

Section 4: ISOFAST Installation

To improve safety and performance, this booster seat is equipped with a unique, one-pull, ISOFAST system that allows secure attachment to a vehicle's lower LATCH anchor locations.

WARNING: Unsecured objects can become flying hazards and can cause serious injury in an accident. Sunshine Kids Juvenile Products® always recommends utilizing ISOFAST installation in vehicles equipped with lower anchors.

- 1) Disengage ISOFAST anchors from storage position.
- 2) Lay booster seat on its side.

- 3) While depressing the cam lock lever (Fig 3.1), pull ISOFAST connectors away from the booster seat and extend both straps all the way. (Fig 3.2)
- 4) Connect both ISOFAST connectors to the vehicle anchors for that seating position. (Fig 4.1)
- 5) Pull adjuster straps toward you with one hand (Fig 4.2) and with the other hand guide booster seat as it is pulled into proper position (Fig 4.3) resting tightly against the vehicle seat back and bottom. (Fig 5)

NOTE: Even with ISOFAST properly attached and adjusted, child seat will still have movement against the vehicle seat back and bottom.

Disengaging ISOFAST installation:

Follow above instructions in reverse:

- 1) Depress the cam lock lever while pulling child seat away from the vehicle seat back until the ISOFAST straps are extended all the way.
- 2) Disconnect ISOFAST connectors from vehicle anchors.
- 3) Pull ISOFAST adjuster strap to recess the ISOFAST connectors into the back of the booster seat bottom for safe storage.

Section 5: Proper Positioning on Vehicle Seat

Place booster seat on vehicle seat so it is resting firmly on vehicle seat bottom and touching the vehicle seat back. (Fig 5)

IMPORTANT: When using the booster seat as a high-back booster, booster backrest must be in full contact with vehicle seat back. (Fig 5) In some cases, you may have to raise the vehicle headrest to properly accommodate the backrest height of the booster seat. It may also be necessary to adjust the recline angle of the booster seat to match that of the vehicle seat. (See section 6)

Section 6: Adjusting the Recline Angle

This booster seat features a recline angle that can adjust to match that of the vehicle seat:

- 1) Push booster seat backrest backwards until you hear a click. Backrest will now pivot freely and does not need to click into another position. (Fig 5)
- 2) Push seat bottom and backrest of booster seat down and back into vehicle seat until there is secure positioning and full contact with the booster seat and vehicle seat bottom and vehicle seat back. (Fig 5)

Section 7: Securing the Child

- 1) Make sure booster seat is properly positioned and installed on vehicle seat as per the instructions in Sections 4 and 5.
- 2) Properly position child: sitting upright and all the way back in the booster seat.
- 3) Make sure booster seat backrest width is adjusted to narrowest width setting that comfortably fits child. (see Section 3)
- 4) Feed the diagonal portion of the seatbelt through the red upper belt guide (Fig 6A) on the side opposite the seatbelt buckle. (Fig 8)
- 5) Fasten seatbelt across child: Lap portion of seatbelt should rest within both red lower belt guides. Diagonal shoulder portion should route inside the red lower belt guide closest to the buckle and over child's shoulder. (Fig 8)
- 6) Adjust headrest (section 3) to proper height: Upper shoulder guide should be slightly above (at least 1 cm) the child's shoulders. (FIG 9)

WARNING: If headrest is adjusted to maximum height and child's shoulder height is closer than 1 cm to the upper belt guide, child is too tall and the seat can only be used as a backless booster.

- 7) Make sure seat belt is not twisted and lays flat across child's lap, torso and shoulder. (Fig 8)
- 8) Tighten the seatbelt by pulling the diagonal shoulder belt portion in the direction of the arrows in Fig 8.
- 9) Confirm seatbelt buckle is in correct position. (see section 8)

Warning: If lap portion and diagonal portion of seatbelt are not positioned correctly, the booster seat is not properly installed: Diagonal portion of seatbelt should lay over the shoulder and NOT touching the neck. (Fig 8)

Lap belt position should be forward and as low as possible over child's pelvis and contacting the upper thigh.

Section 8: Proper buckle position

IMPORTANT: After booster seat is installed and seatbelt is fastened around child, it is important to confirm correct seatbelt buckle position to ensure secure installation. Correct seatbelt buckle position (Figs 8 and 12): Buckle is on the outside of lower belt guide. Incorrect seat belt buckle position (Fig 10): If buckle is being pulled across the lower belt guide and into the seat, choose another seating position within the vehicle.

Section 9: Backless Booster Seat Use

While this booster seat is designed to offer advanced side-impact protection with its backrest section attached, the seat bottom can also be used alone as a backless booster.

- 1) Remove seat bottom from backrest section. (page 12)
- 2) Unfold padded fabric flap on back of seat bottom. (Fig 11A)
- 3) Make sure booster seat is correctly installed (sections 4 & 5) and properly positioned on vehicle seat. (Fig 11)
- 4) Properly position child: sitting upright and all the way back in the booster seat.
- 5) Fasten seatbelt across child.

- 6) Make sure seat belt is not twisted and lays flat across child's hips, torso and shoulder.
- 7) Tighten the seatbelt by pulling the diagonal shoulder belt portion in the direction of the arrows in (Fig 12).

IMPORTANT: Lap belt position should be as far forward and as low as possible over child's pelvis and contacting upper thighs.

IMPORTANT: Diagonal seat belt portion should route inside the red lower belt guide closest to the buckle and over child's shoulder. It should NOT be touching the neck (Fig 12).

NEVER position the shoulder belt loosely or under the child's arm or behind their back.

WARNING: If the diagonal seat belt portion does not correctly fit the child, then the seat must only be used with the seatback portion attached and properly adjusted to fit the child.

Section 10: Care and maintenance

Cleaning the cover:

Read all labels attached to cover for washing instructions.

Hand wash cover cold water with mild detergent only.

Line dry to prevent shrinkage.

Do NOT wash cover in hot water.

Do NOT bleach, machine wash or machine dry.

Cleaning the shell:

Sponge clean ONLY using warm water and mild soap. Towel dry when finished. Do NOT use solvents, detergents or any other chemical or cleaning agent. Do NOT lubricate any part of the seat.

Removing the fabric cover:

- 1) Separate seat back section from seat bottom section.
- 2) Remove plastic fasteners and elastics that secure fabric cover to seat bottom, seat back and head rest.
- 3) Remove fabric cover pieces from the booster seat sections.

Attaching the cover:

Follow the above instructions in reverse.

Section 11: Warranty

This child booster seat was manufactured by Sunshine Kids Juvenile Products® (“Sunshine Kids”). Sunshine Kids warrants this product to the original retail purchaser as follows.

Limited one-year warranty:

This product is warranted solely to the retail customer who purchased the product against defective materials or workmanship for one year from original date of retail purchase. Proof of purchase is required. The exclusive remedy for this warranty is that Sunshine Kids will, at its option, replace, repair or provide replacement components for this product or may refund the original purchase price of this product. Sunshine Kids reserves the right to change fabrics, parts, product model or to make substitutions. To initiate a claim under this warranty, please contact Sunshine Kids at 1-888-336-7909 or contact us using the address on the back of this instruction manual.

Please register this product within 30 days of original date of purchase, by completing and mailing the registration card.

Warranty Limitations:

This warranty does not include damage arising directly or indirectly from negligence, misuse or unapproved use by the retail customer which are not in accordance with instructions contained in the product instruction manual or Federal governmental safety guidelines for the use of such products.

Using any other manufacturers product, or any product not specifically approved by Sunshine Kids Juvenile Products® for use with this restraint is not allowed. Use of such products could seriously impair this product's ability to perform properly in an accident and could cause it to fail Federal Motor Vehicle Safety Standards. Any such use will result in the voiding of the warranty provided hereunder.

Limitations of Damages:

The warranty and remedies set forth above are sole and exclusive remedies with respect to the product and are in lieu of all others, whether oral or written expressed or implied. In no event whatsoever, will Sunshine Kids or a retailer of this product be liable for any damages, including those incidental or consequential, arising out the use of this product.

Warranty limitations and other warranty terms and conditions:

The express warranty provided hereunder is in lieu of any implied warranties, including implied warranties of merchantability and appropriateness for a particular purpose, and shall be limited to the duration and terms of this express written warranty unless otherwise restricted by applicable state law. This warranty grants you specific legal rights. Neither Sunshine Kids, nor any retailer selling this product, authorizes any other person or party to create for it any other warranty, obligation, or liability in connection with this product.



SK MBS US Rev7 021908